

100er 42CrMo4 Welle ohne Bohrung

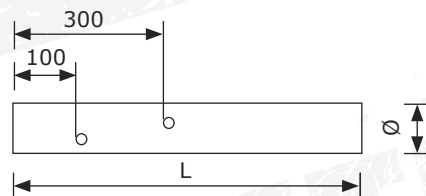

| Ø | L | Material | Lagernummer |
|--------|---------|----------|-----------------|
| 100 mm | 600 mm | 42CrMo4* | 943 100 600 000 |
| 100 mm | 1000 mm | 42CrMo4* | 943 100 999 000 |

100er SW - Schmierwellen mit Splintbohrung



| Ø | L | Material | Lagernummer |
|--------|--------|----------|-----------------|
| 100 mm | 700 mm | 42CrMo4* | 943 100 700 000 |

100er Sonder-Hohlbolzen

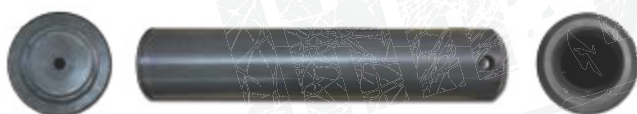

mit Seegeringstich

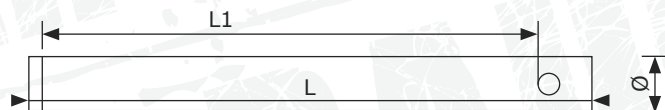

| Ø | Bohrung | L | L1 | Material | Lagernummer |
|--------|---------|--------|--------|----------|-----------------|
| 100 mm | M20 | 487 mm | 440 mm | - | 943 100 440 020 |

100er/4" Laschen

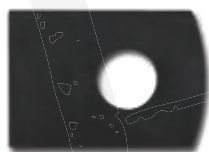

LA 00

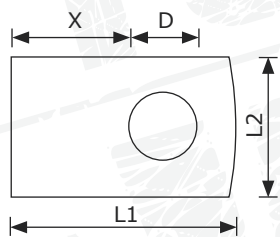

| Art | D Ø | L1 | L2 | X | Y | B | Stärke | Lagernummer |
|-------|---------------|--------|--------|--------|---|---|--------|-----------------|
| LA 00 | 4" (101,6 mm) | 240 mm | 140 mm | 120 mm | - | - | 8 mm | 901 103 240 140 |
| LA 00 | 100 mm | 210 mm | 120 mm | 99 mm | - | - | 12 mm | 901 100 210 120 |



Schmiernippel gerade H1 M12x1

917 000 012 349

* 72h langzeit gasnitriert, gehärtet und geschliffen
Schmiernippel M12 im Lieferumfang enthalten!
Laschen nicht gehärtet! Material ST52-3